

REVISIONS				
REV.	DESCRIPTION	DATE	DRAWN	APPROVED
A	DAWING RELEASE	4/18/16	MH	MG

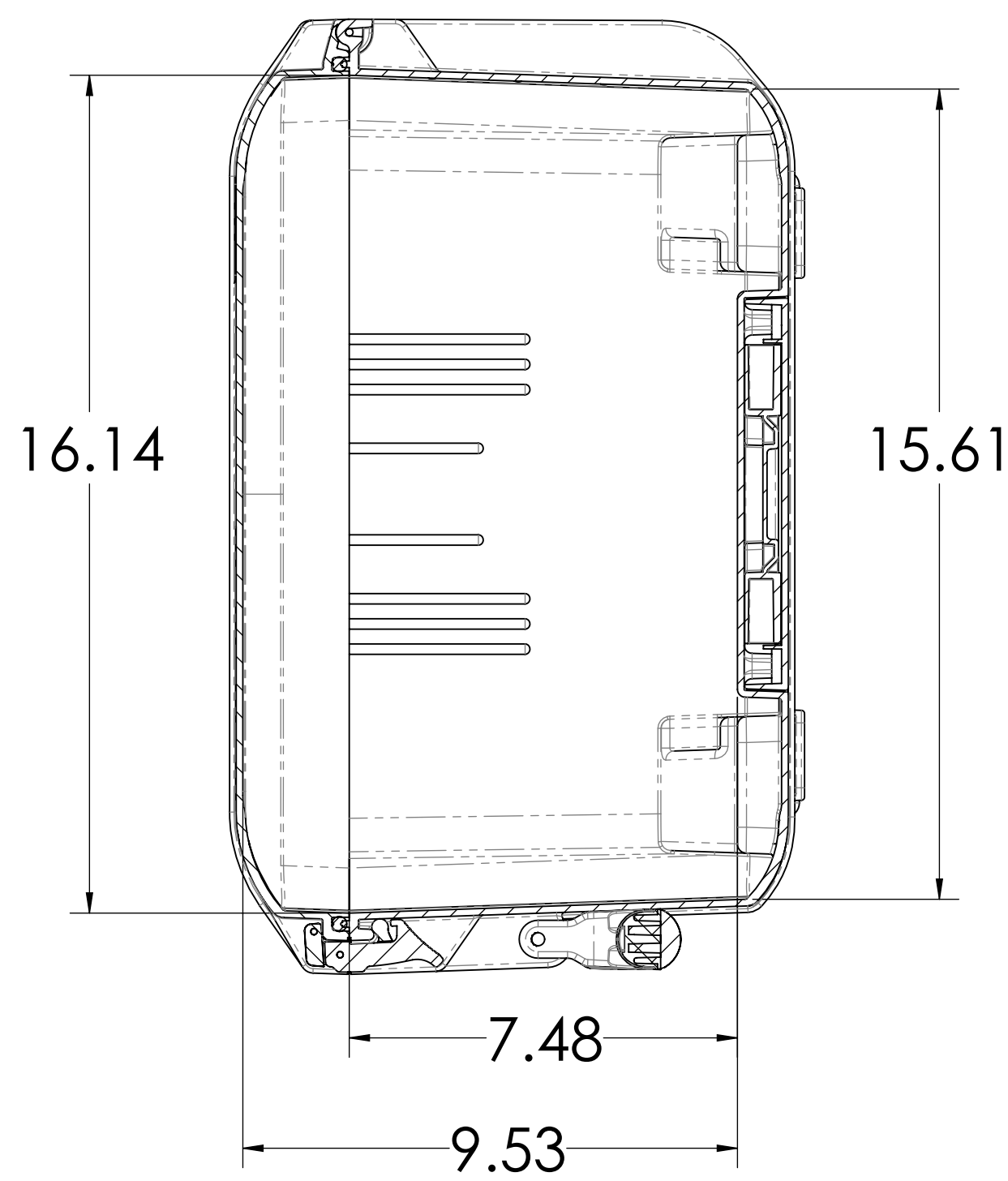

SECTION B-B
SCALE 1 : 3

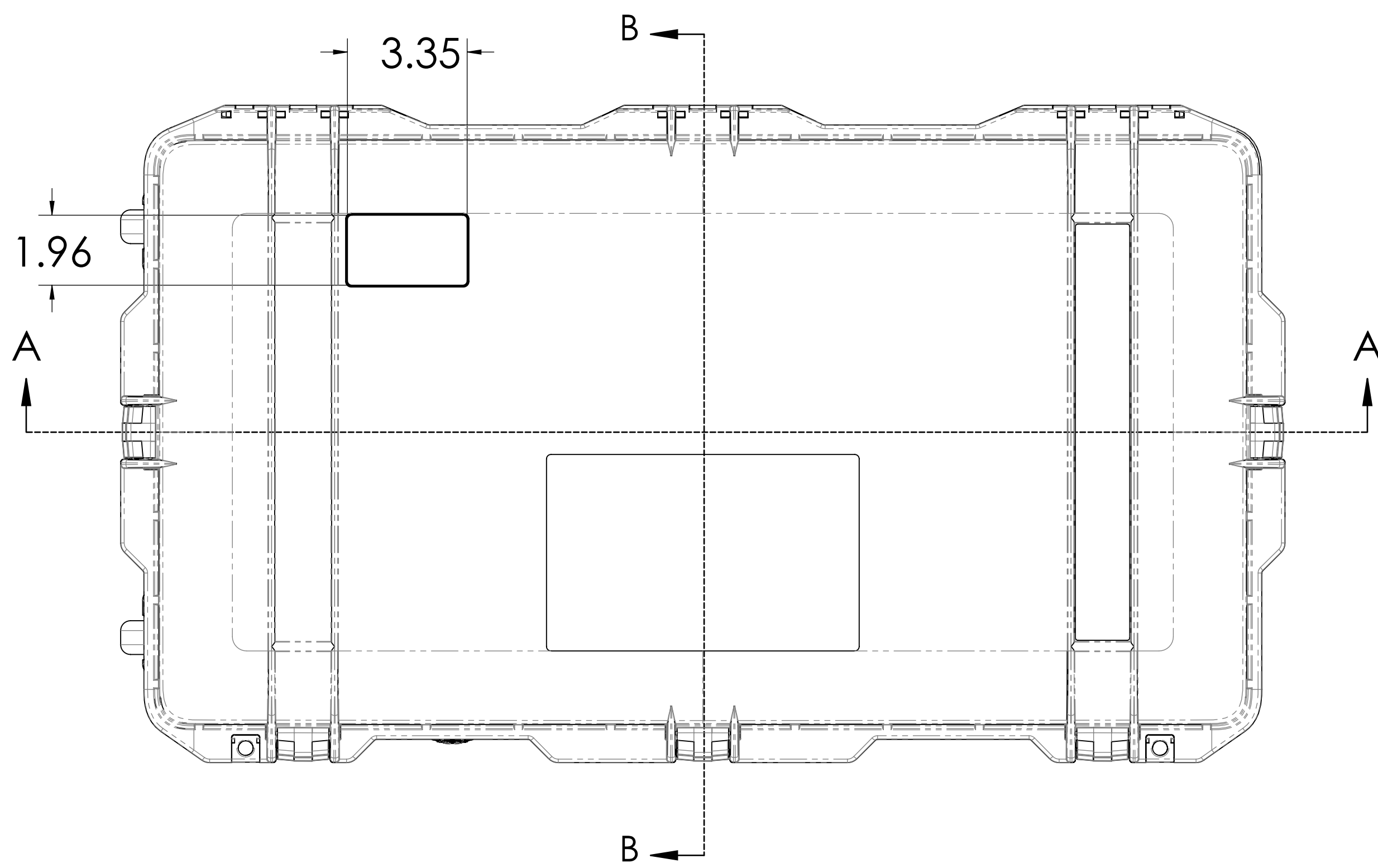
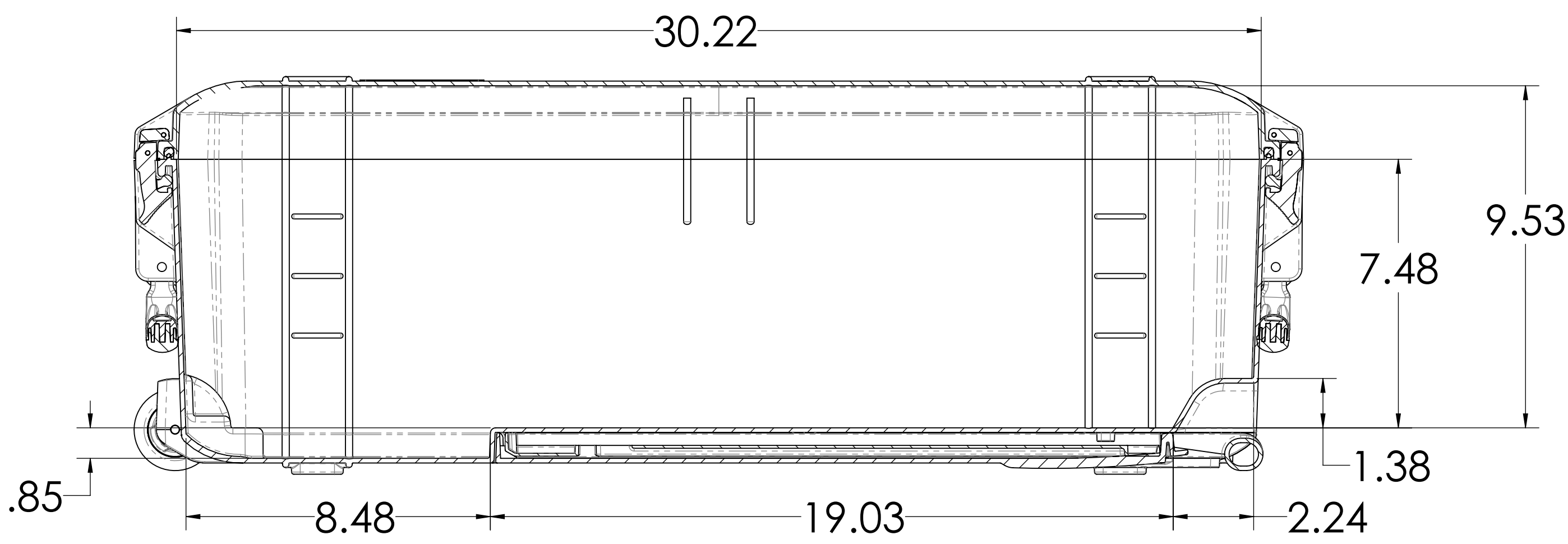
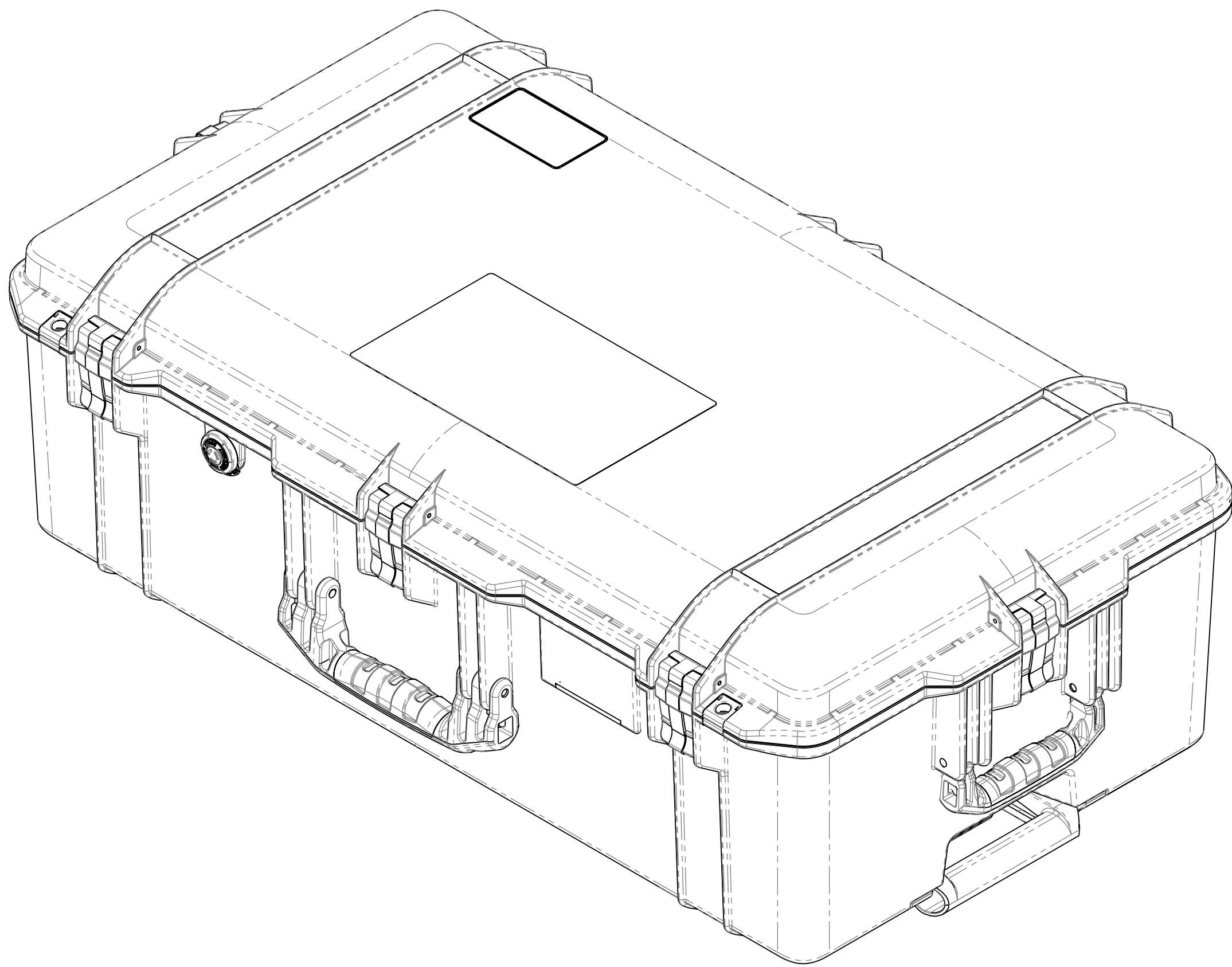

SECTION A-A
SCALE 1 : 3

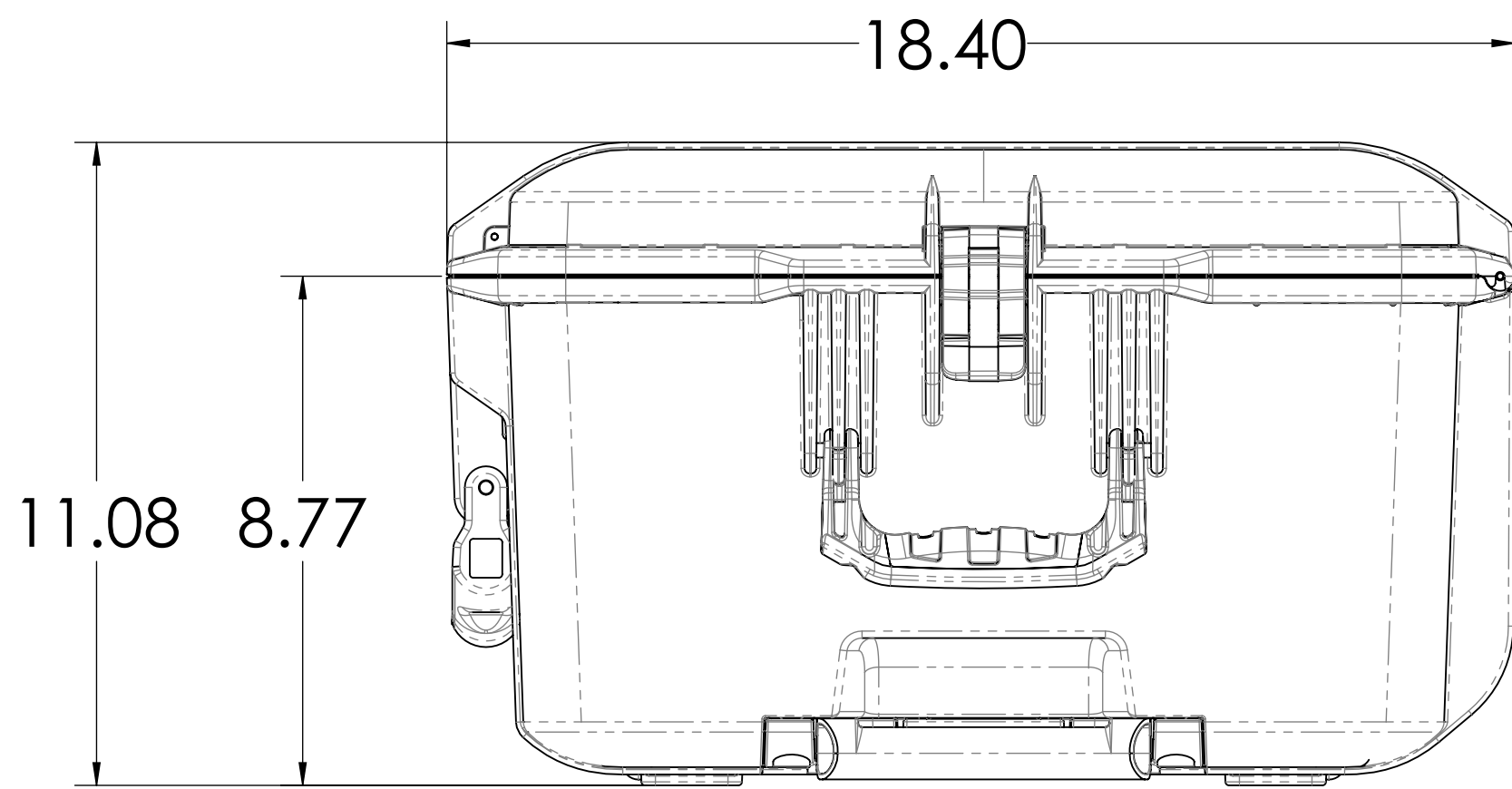
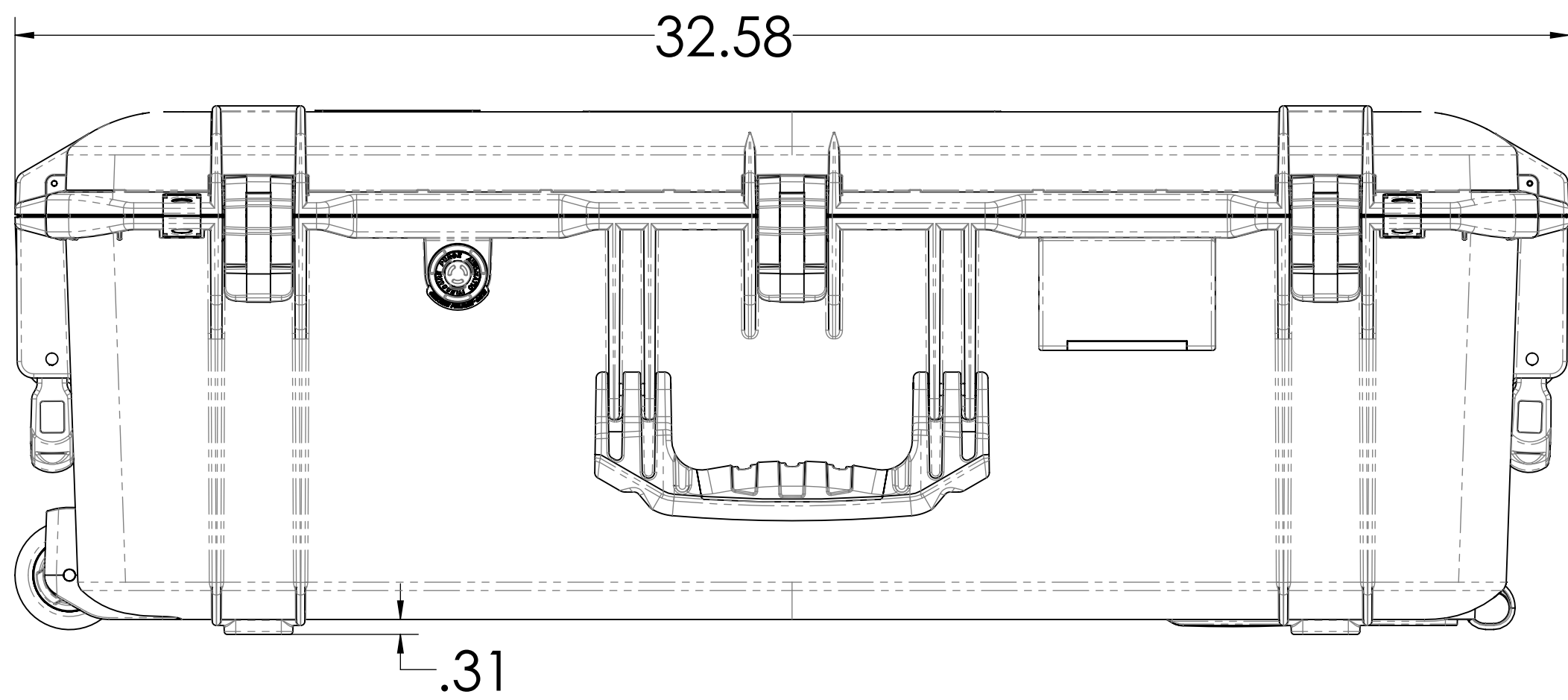

4: CASE INTERIOR CORNERS ARE NOT TRUE RADIUS.
3: FOR DETAILED INTERNAL DIMENSIONS SEE STEP OR IGES FILE.
2: PRODUCT MUST BE REACH AND RoHS COMPLIANT.
1- MATERIAL: POLYPROPYLENE.
NOTE: UNLESS OTHERWISE SPECIFIED.

TOLERANCE BLOCK	
INCHES	.XX <10.00 ±.03 .XXX ≥10.00 ±.003 PER INCH
mm	X <254 ±0.75 .X ≥254 ±0.003 PER mm
ANGLES	° ±.25°



APPROVALS DATE		PELICAN PRODUCTS INC.	
DESIGN	XX XXXX	23215 EARLY AVE., TORRANCE, CA 90505 (310) 326-4700	
APPROVED		TITLE 1615 CASE ASSMBLY INTERIOR AND EXTERIOR DIMENSION	
SIZE	SCALE	DRAWING NO.	REV
E	1:2	016150-0000-CLR	A
DO NOT SCALE DRAWING		SHEET	OF
		1	3

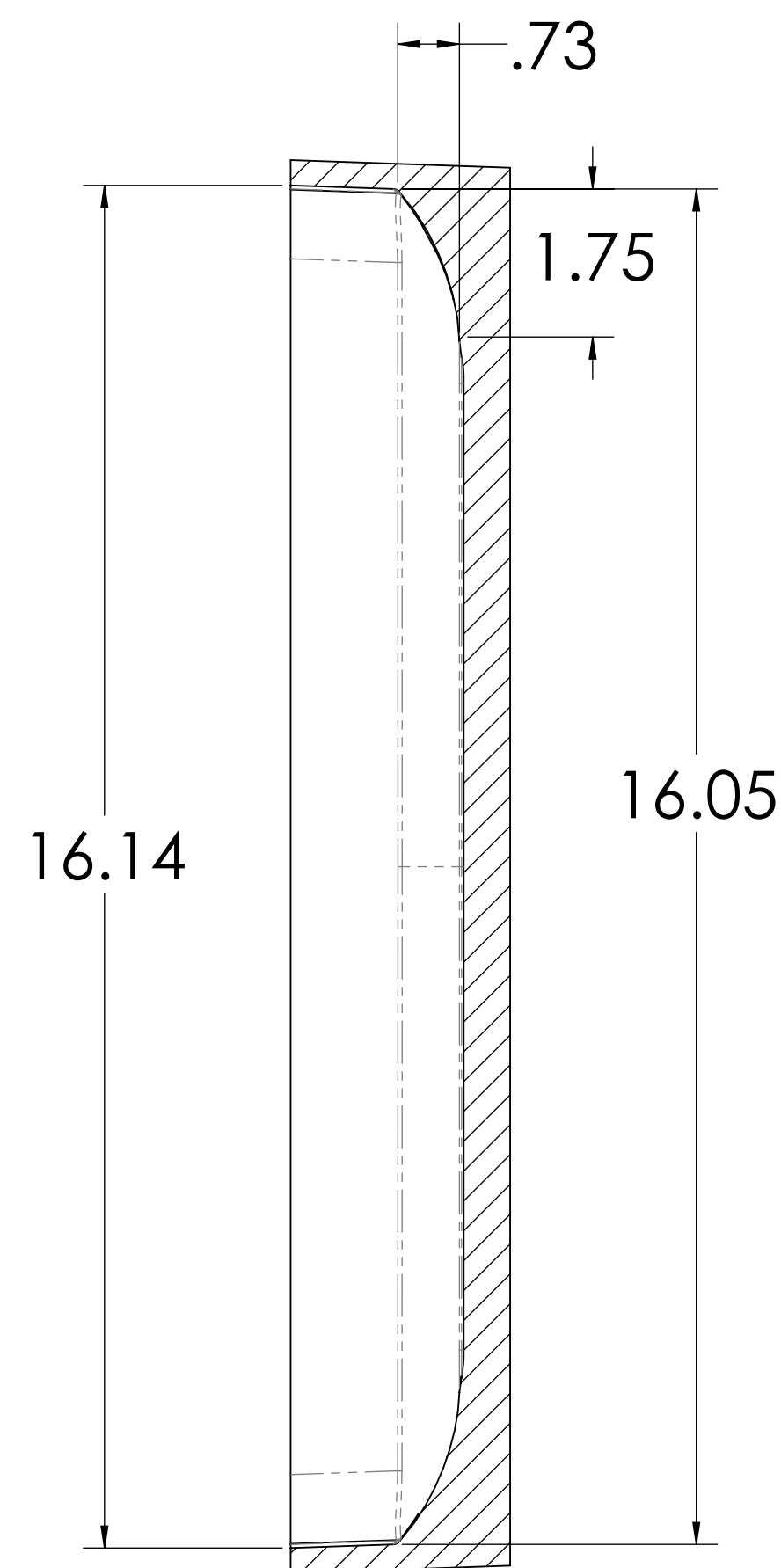
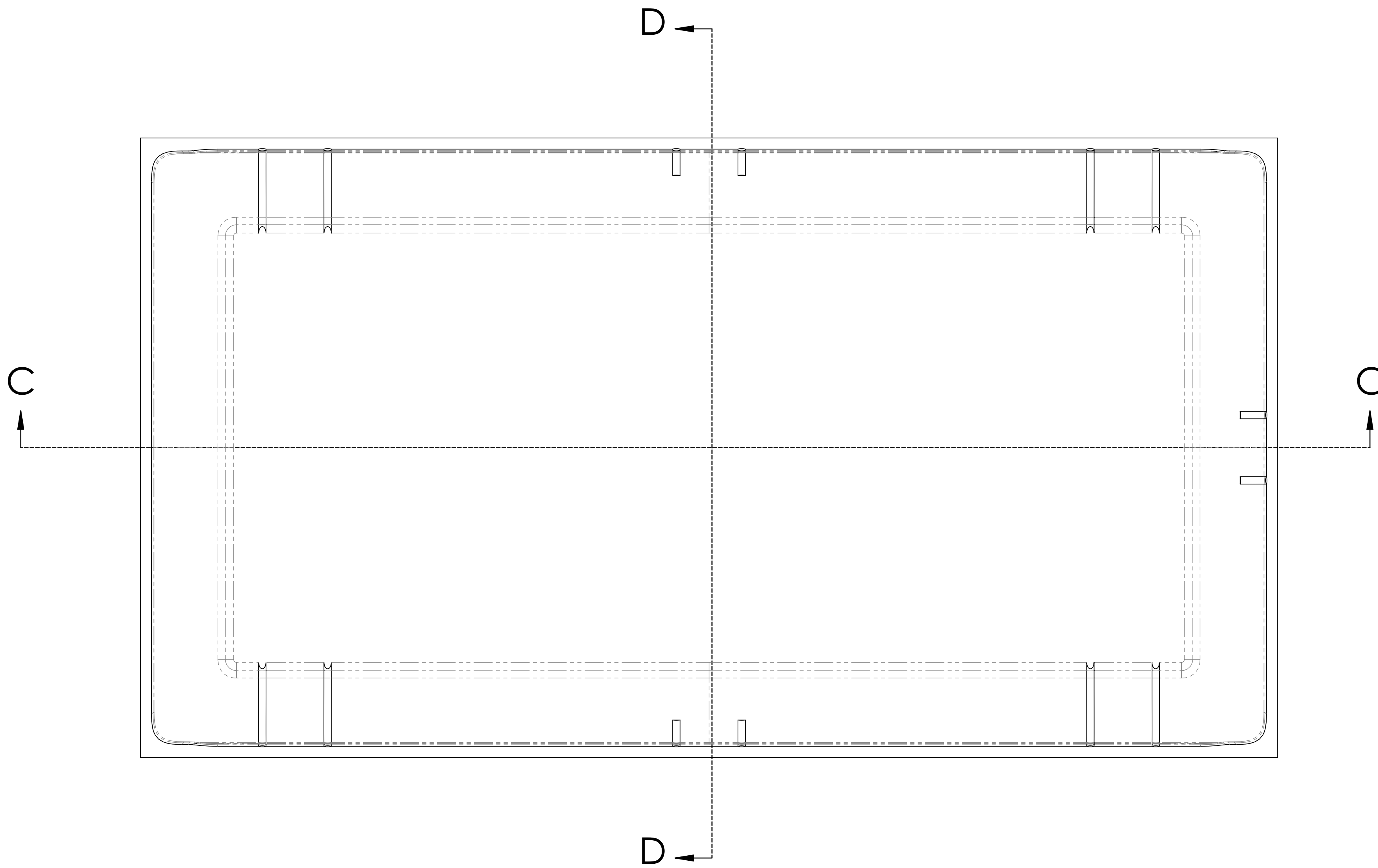

SECTION D-D

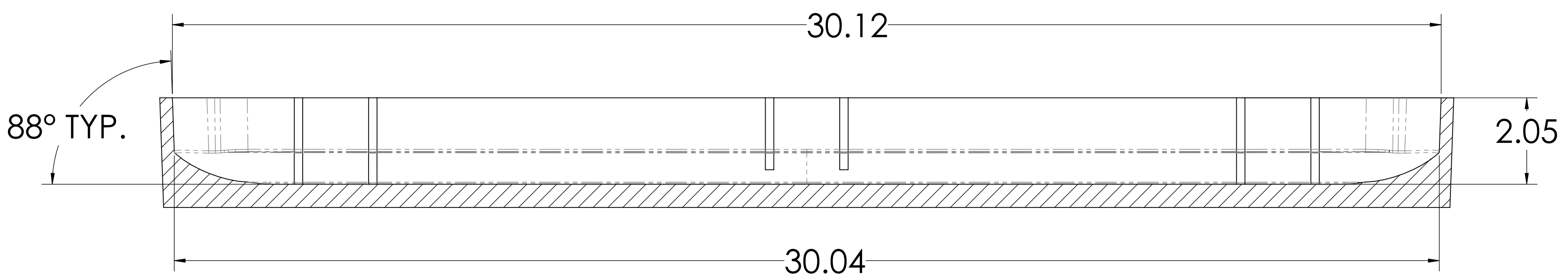

SECTION C-C

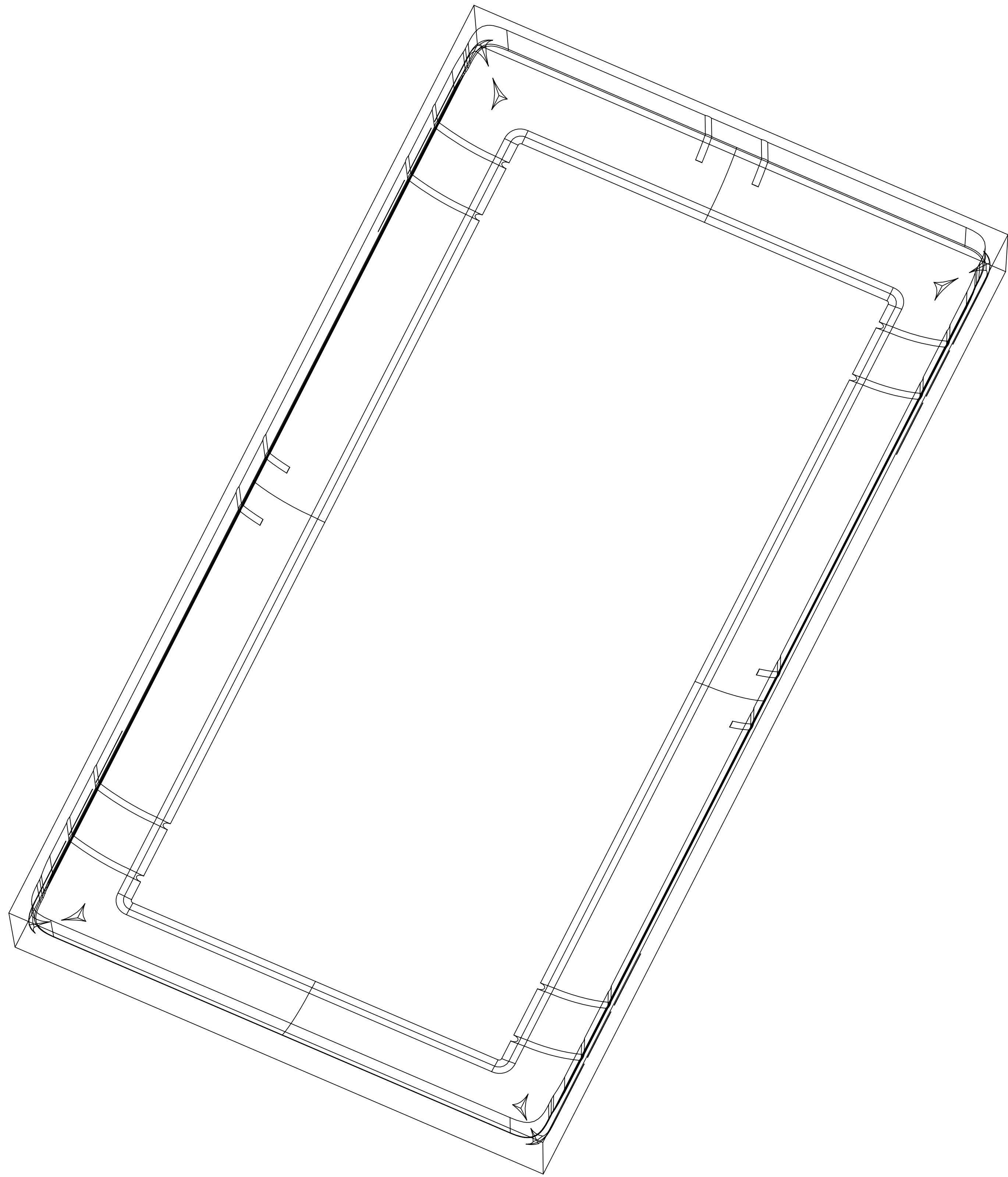

1615 TOP TUB DRAWING INTERIOR DIMENSION

4: CASE INTERIOR CORNERS ARE NOT TRUE RADIUS.
3: FOR DETAILED INTERNAL DIMENSIONS SEE STEP OR IGES FILE.
2: PRODUCT MUST BE REACH AND RoHS COMPLIANT.
1- MATERIAL: POLYPROPYLENE.
NOTE: UNLESS OTHERWISE SPECIFIED.

TOLERANCE BLOCK		APPROVALS DATE		PELICAN PRODUCTS INC.	
INCHES	.XX	<10.00	±.03	DATE	23215 EARLY AVE., TORRANCE, CA 90505 (310) 326-4700
	.XXX	±10.00	±.003 PER INCH	CHECKED	
mm	X	±.005		APPROVED	
	X	<254	±0.75		
	X	>254	±0.003 PER mm		
ANGLES	°	±.25°			
This Drawing contains information proprietary to Pelican Products Inc. Any reproduction, disclosure or use of this drawing requires written the permission of Pelican Products Inc.		DO NOT SCALE DRAWING		SHEET 2 OF 3	

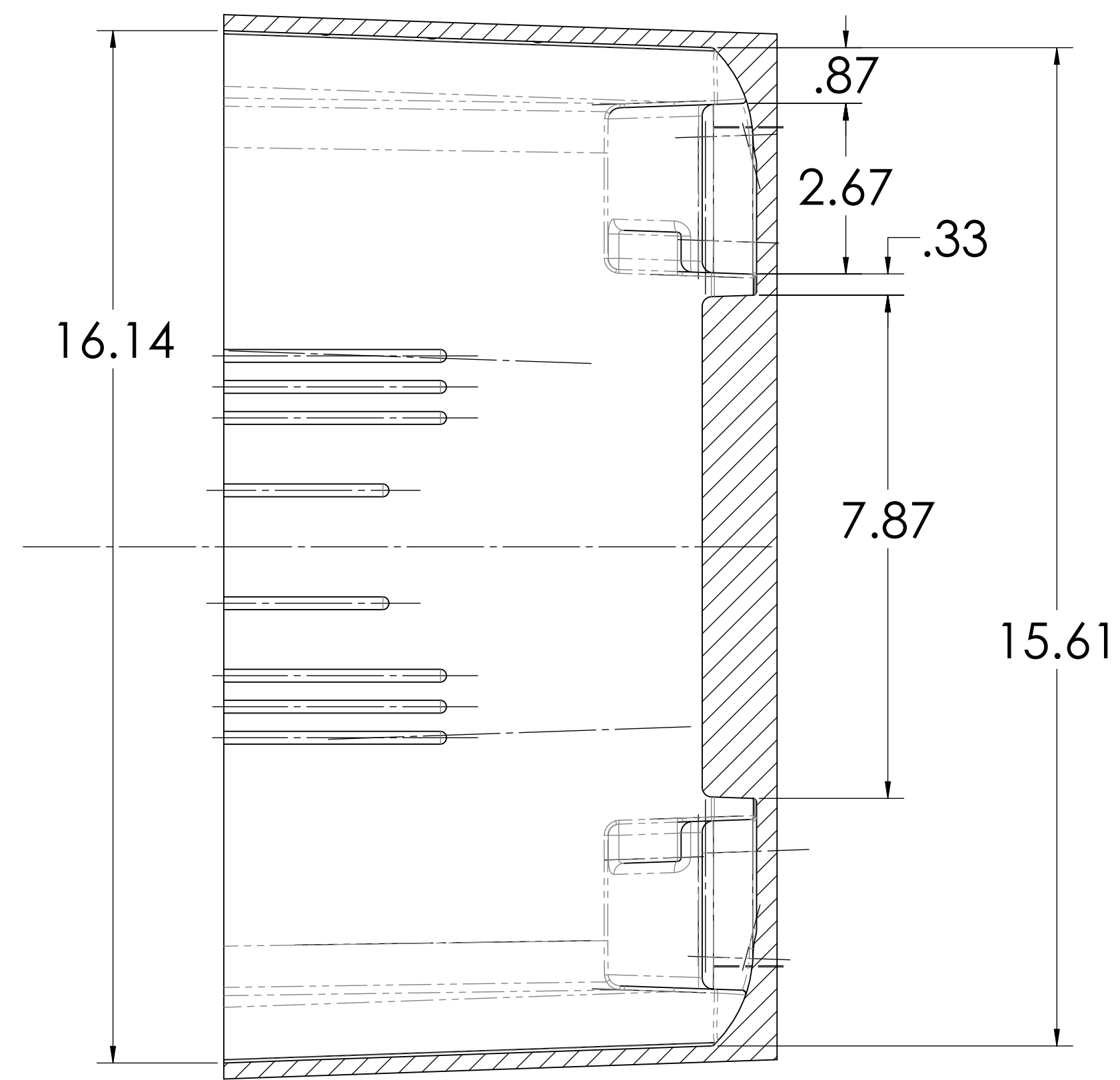
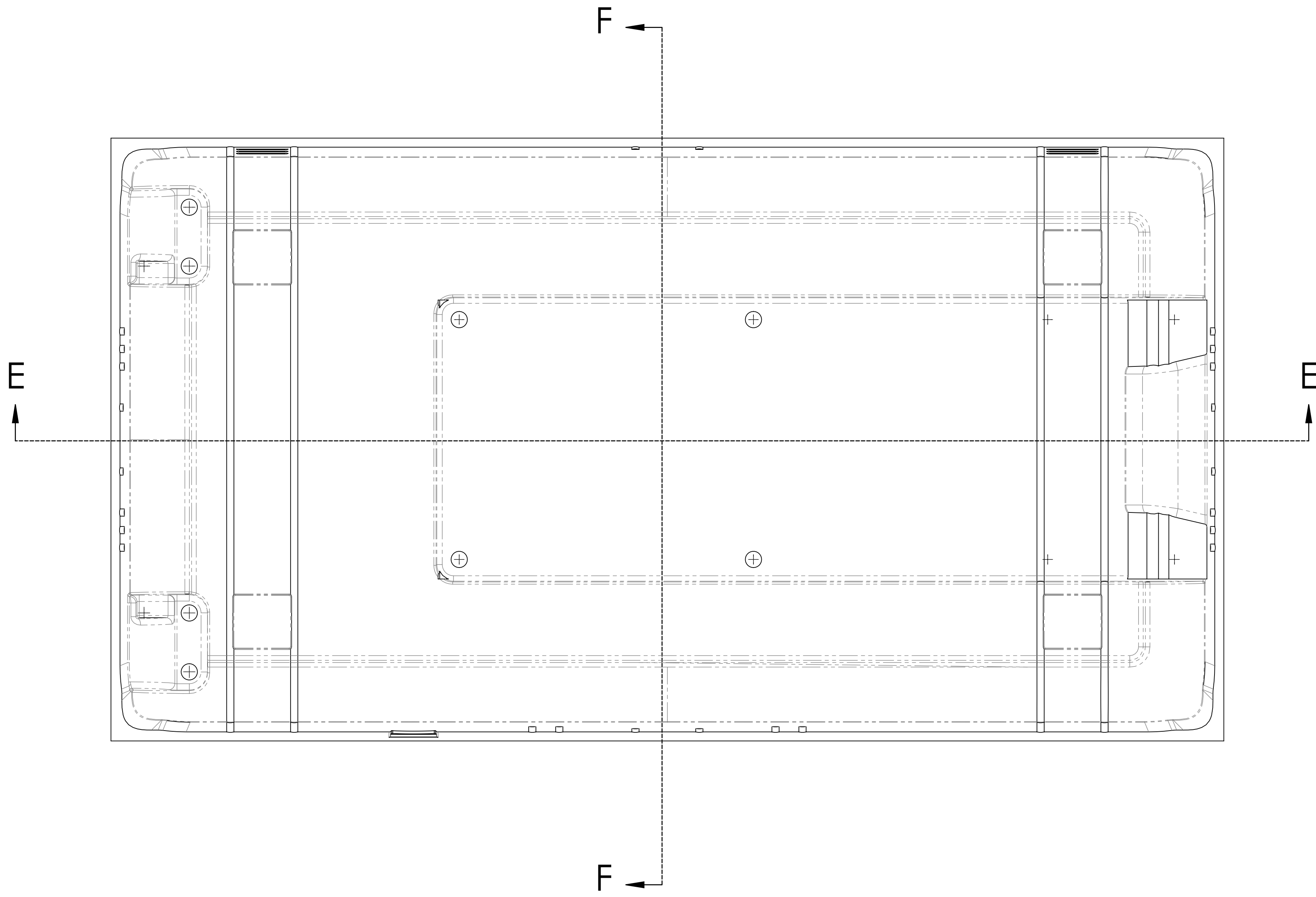

SECTION F-F

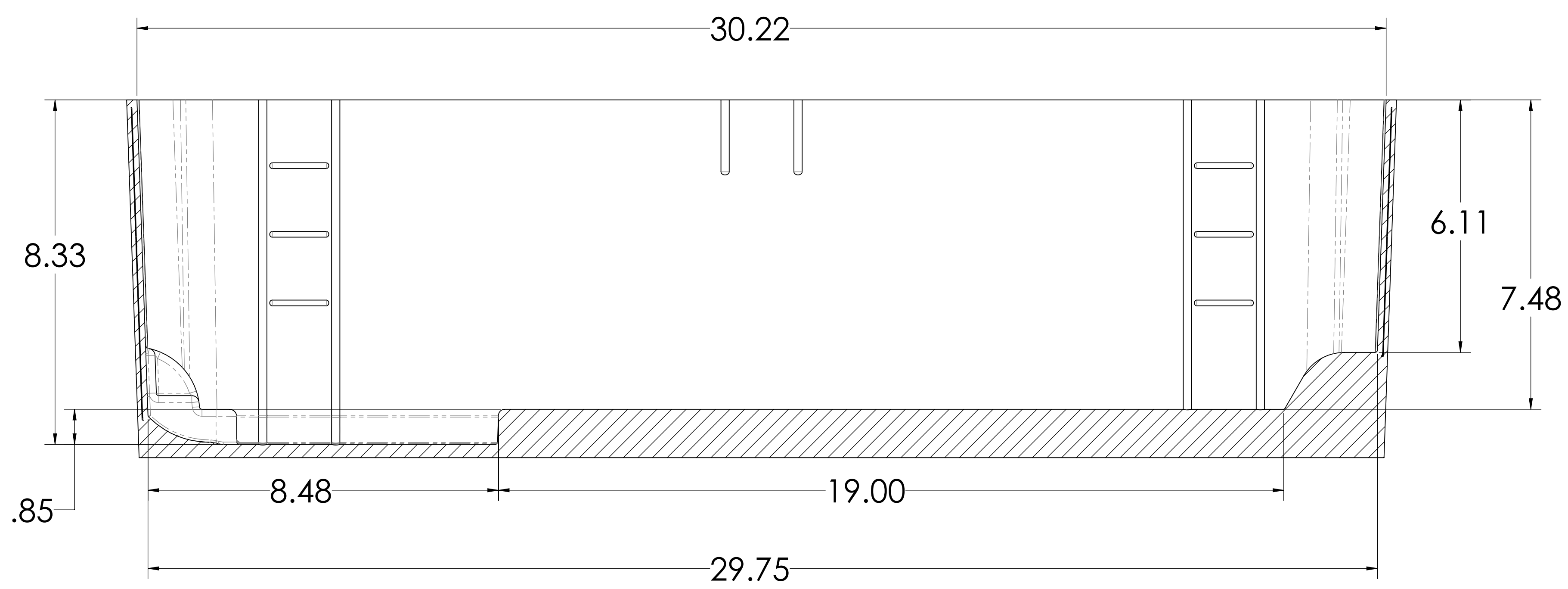

SECTION E-E

1615 BOTTOM TUB DRAWING INTERIOR DIMENSION

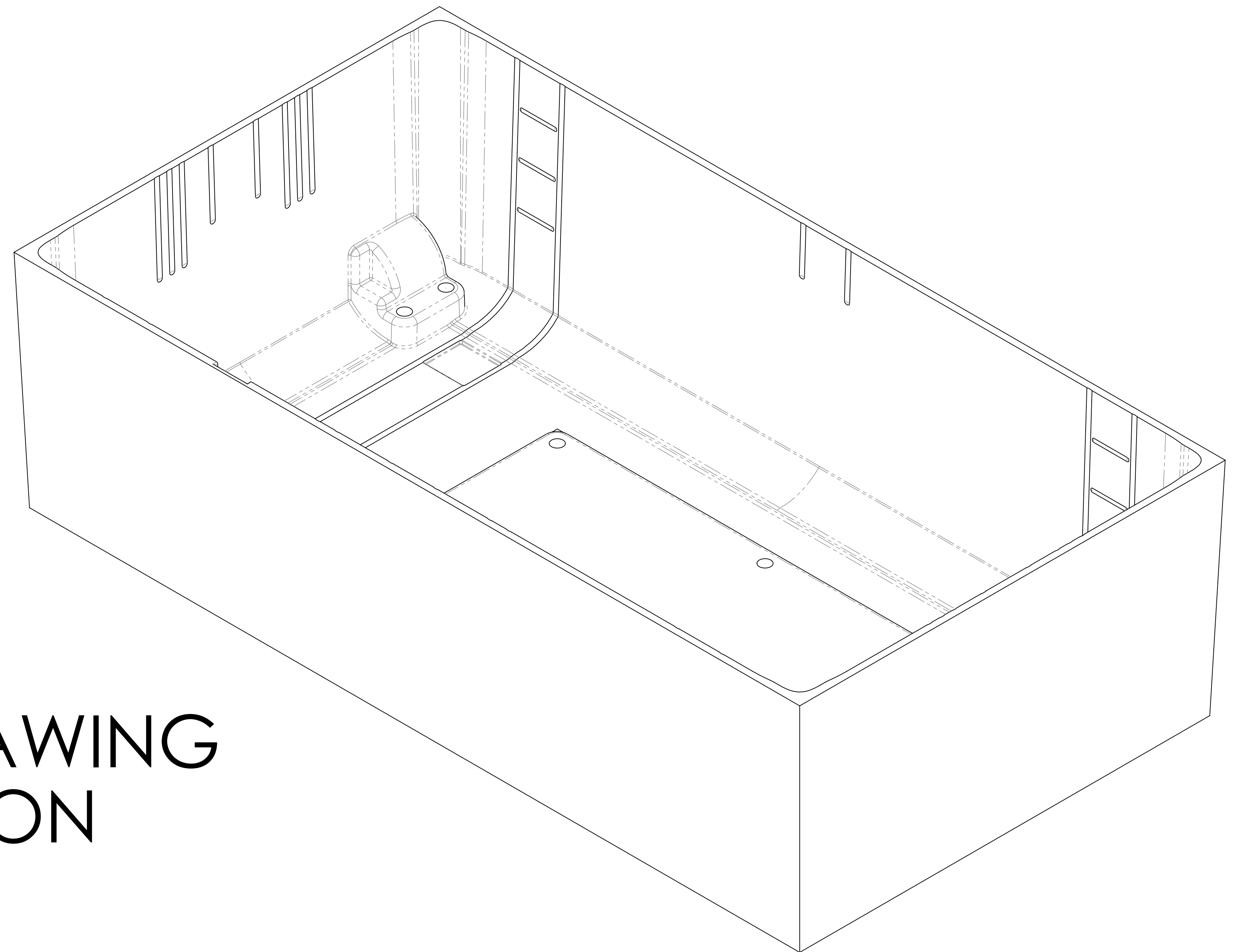

4: CASE INTERIOR CORNERS ARE NOT TRUE RADIUS.
3: FOR DETAILED INTERNAL DIMENSIONS SEE STEP OR IGES FILE.
2: PRODUCT MUST BE REACH AND RoHS COMPLIANT.
1- MATERIAL: POLYPROPYLENE.
NOTE: UNLESS OTHERWISE SPECIFIED.

TOLERANCE BLOCK		APPROVALS DATE		PELICAN PRODUCTS INC.	
INCHES	.XX	<10.00	±.03	DATE	23215 EARLY AVE, TORRANCE, CA 90505 (310) 326-4700
	.XXX	>10.00	±.003 PER INCH	APPROVED	
mm	X	<254	±0.75	TITLE 1615 BOTTOM TUB DRAWING	
	.X	>254	±0.003 PER mm		
ANGLES	°	±.25°		SIZE	DRAWING NO.
	°			SCALE	REV
DO NOT SCALE DRAWING				1:2	A
				SHEET 3 OF 3	